

# Kit 1061

**HONDA Concerto**, 5-dr Hatchback, 89-98

**ROVER 200**, 3-dr Hatchback, 90-95

**ROVER 200**, 4-dr Sedan, 90-95

**ROVER 200**, 5-dr Hatchback, 90-95

**ROVER 400**, 4-dr Sedan, 90-95

**ROVER 400**, 5-dr Hatchback, 90-95

480R  
754

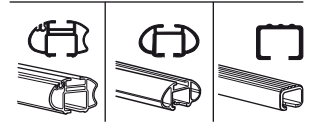
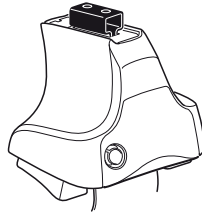

480

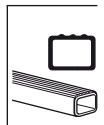
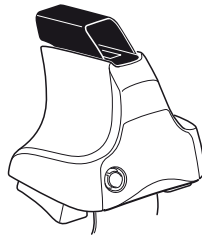

750

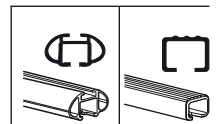
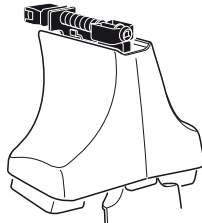

**THULE**<sup>®</sup>  
SWEDEN

**Kit**



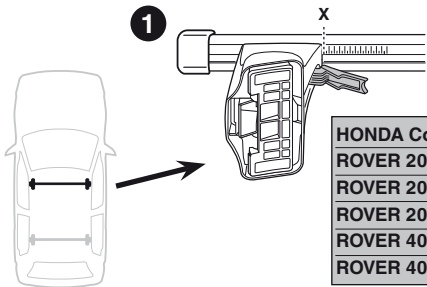
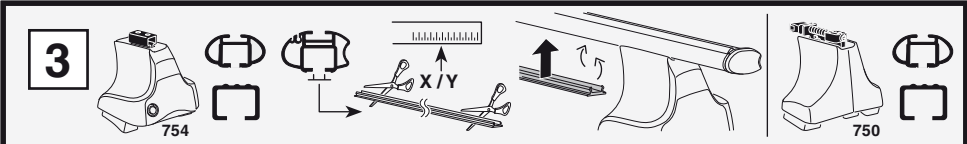

	X
<b>HONDA Concerto</b> , 5-dr Hatchback, 89-98	31,5
<b>ROVER 200</b> , 3-dr Hatchback, 90-95	31,5
<b>ROVER 200</b> , 4-dr Sedan, 90-95	31,5
<b>ROVER 200</b> , 5-dr Hatchback, 90-95	31,5
<b>ROVER 400</b> , 4-dr Sedan, 90-95	31,5
<b>ROVER 400</b> , 5-dr Hatchback, 90-95	31,5

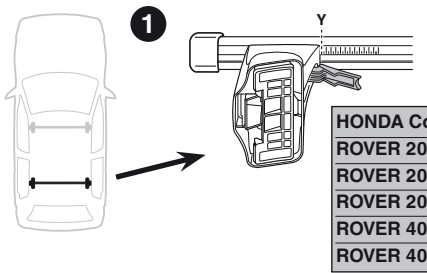

	Y
<b>HONDA Concerto</b> , 5-dr Hatchback, 89-98	28
<b>ROVER 200</b> , 3-dr Hatchback, 90-95	28,5
<b>ROVER 200</b> , 4-dr Sedan, 90-95	28
<b>ROVER 200</b> , 5-dr Hatchback, 90-95	28
<b>ROVER 400</b> , 4-dr Sedan, 90-95	28
<b>ROVER 400</b> , 5-dr Hatchback, 90-95	28

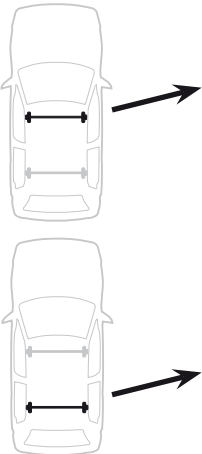
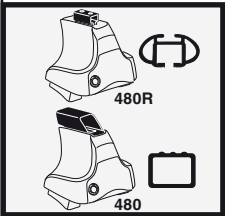

	X inch	X mm
<b>HONDA Concerto</b> , 5-dr Hatchback, 89-98	38"	966 mm
<b>ROVER 200</b> , 3-dr Hatchback, 90-95	38"	966 mm
<b>ROVER 200</b> , 4-dr Sedan, 90-95	38"	966 mm
<b>ROVER 200</b> , 5-dr Hatchback, 90-95	38"	966 mm
<b>ROVER 400</b> , 4-dr Sedan, 90-95	38"	966 mm
<b>ROVER 400</b> , 5-dr Hatchback, 90-95	38"	966 mm

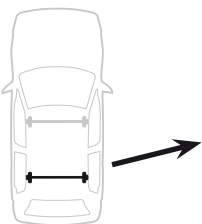

	Y inch	Y mm
<b>HONDA Concerto</b> , 5-dr Hatchback, 89-98	36 <sup>5</sup> / <sub>8</sub> "	931 mm
<b>ROVER 200</b> , 3-dr Hatchback, 90-95	36 <sup>7</sup> / <sub>8</sub> "	936 mm
<b>ROVER 200</b> , 4-dr Sedan, 90-95	36 <sup>5</sup> / <sub>8</sub> "	931 mm
<b>ROVER 200</b> , 5-dr Hatchback, 90-95	36 <sup>5</sup> / <sub>8</sub> "	931 mm
<b>ROVER 400</b> , 4-dr Sedan, 90-95	36 <sup>5</sup> / <sub>8</sub> "	931 mm
<b>ROVER 400</b> , 5-dr Hatchback, 90-95	36 <sup>5</sup> / <sub>8</sub> "	931 mm

4

ROVER 200, 3-dr Hatchback, 90-95

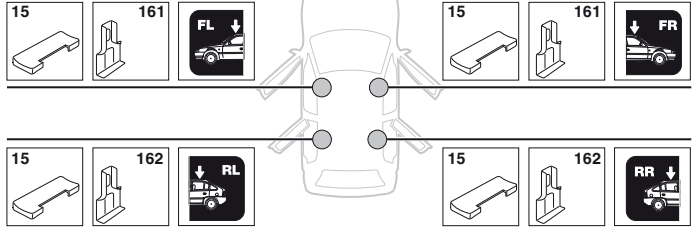

HONDA Concerto, 5-dr Hatchback, 89-98

ROVER 200, 4-dr Sedan, 90-95

ROVER 200, 5-dr Hatchback, 90-95

ROVER 400, 4-dr Sedan, 90-95

ROVER 400, 5-dr Hatchback, 90-95

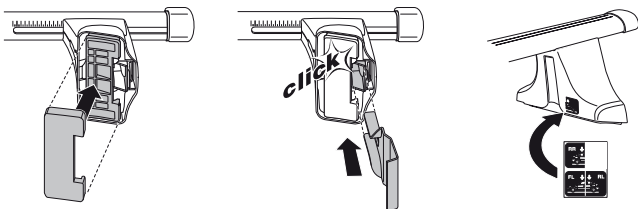
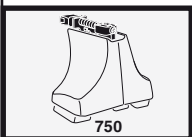
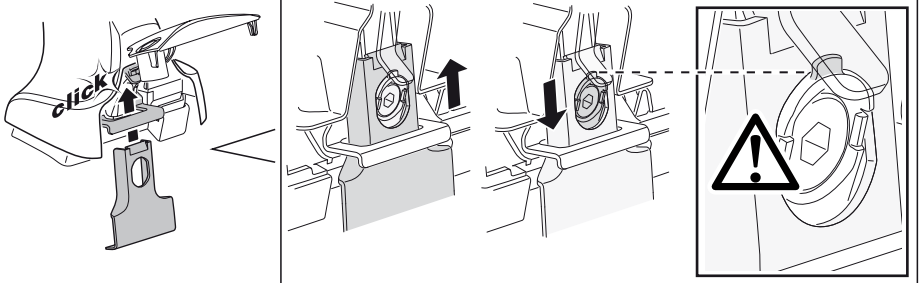
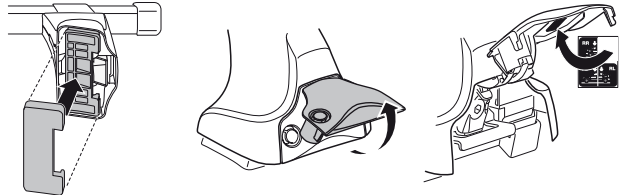
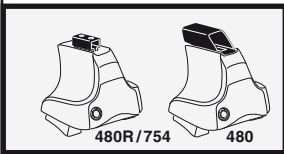
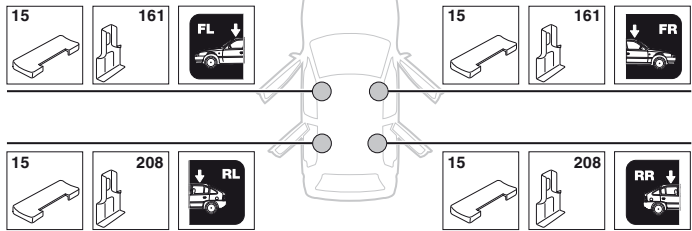

5

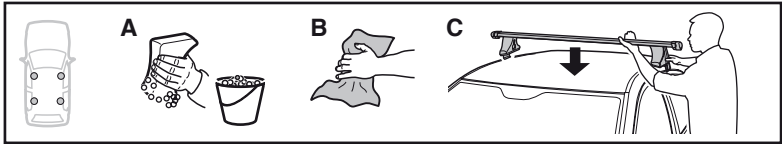

	X mm	Y mm	X inch	Y inch
<b>HONDA Concerto</b> , 5-dr Hatchback, 89-98	240 mm	700 mm	9 1/2"	27 1/2"
<b>ROVER 200</b> , 3-dr Hatchback, 90-95	240 mm	620mm	9 1/2"	24 3/8"
<b>ROVER 200</b> , 4-dr Sedan, 90-95	200 mm	700 mm	7 7/8"	27 1/2"
<b>ROVER 200</b> , 5-dr Hatchback, 90-95	200 mm	700 mm	7 7/8"	27 1/2"
<b>ROVER 400</b> , 4-dr Sedan, 90-95	240 mm	700 mm	9 1/2"	27 1/2"
<b>ROVER 400</b> , 5-dr Hatchback, 90-95	240 mm	700 mm	9 1/2"	27 1/2"

**ROVER 200**, 3-dr Hatchback, 90-95

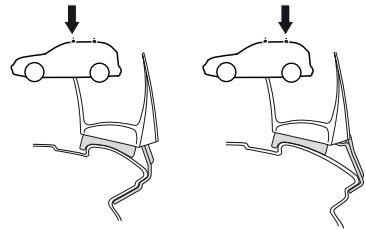
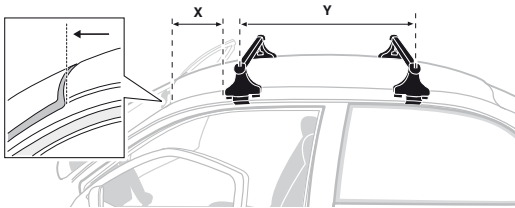

- HONDA Concerto**, 5-dr Hatchback, 89-98
- ROVER 200**, 4-dr Sedan, 90-95
- ROVER 200**, 5-dr Hatchback, 90-95
- ROVER 400**, 4-dr Sedan, 90-95
- ROVER 400**, 5-dr Hatchback, 90-95

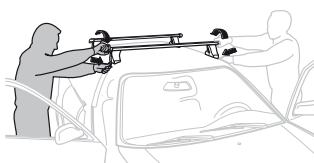
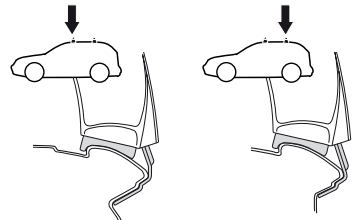
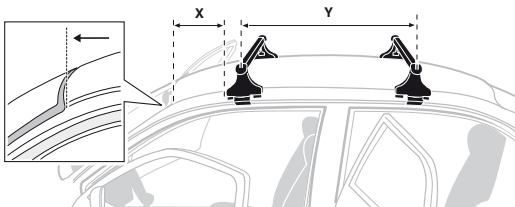

- |              |   |            |   |
|--------------|---|------------|---|
| <b>GB/US</b> | Tighten alternately                                     | <b>CZ</b>  | Pokřetřa bařaznřka dokřeřaj dokřeřaj napřzemiennie. |
| <b>D</b>     | Die Schrauben abwechselnd anziehen                      | <b>SK</b>  | Dofahujte striedavo                                 |
| <b>F</b>     | Serrer alternativement chaque cōtē                      | <b>SLO</b> | Privijajte izmenično.                               |
| <b>NL</b>    | Afwisselend aan de linker- en de rechterkant aandraaien | <b>HR</b>  | Naizmjenično zategnite                              |
| <b>I</b>     | Alternare il serraggio delle viti                       | <b>HU</b>  | Egymástól függgetlenül szorítandó                   |
| <b>E</b>     | Apretar alternativamente                                | <b>GR</b>  | Σφιγγετε εναλλάξ                                    |
| <b>PT</b>    | Aperte alternadamente                                   | <b>TR</b>  | Dönüşümlü sıkın                                     |
| <b>S</b>     | Dra åt växelvis   | <b>中文</b>  | 交替拧紧  |
| <b>FIN</b>   | Kierrä vuorotellen                                      | <b>한국어</b> | 변갈아 가며 조이십시오.                                       |
| <b>EST</b>   | Pinguldage vaheldumisi                                  | <b>日本語</b> | 交互に締め付けてください。                                       |
| <b>LAT</b>   | Pielveiciet pamišus                                     | <b>ไทย</b> | ขันน้ในแบบสลับ                                      |
| <b>LIT</b>   | Užsukinėkite pakaitomis                                 |            |   |
| <b>PL</b>    | Śruby dokręćaj naprzemiennie                            |            |   |
| <b>RU</b>    | Затягивайте попеременно                                 |            |   |

6



480R/754



480

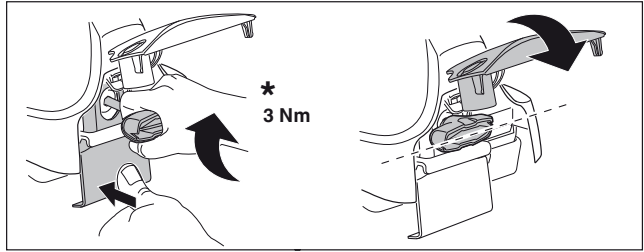
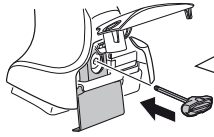

\*  
3 Nm



\*

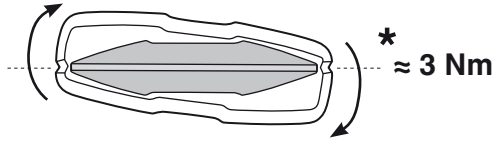

\*  
≈ 3 Nm

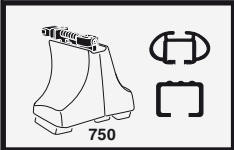
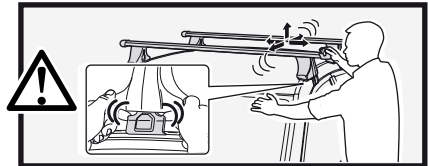

750

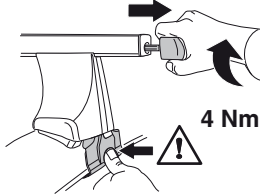

4 Nm

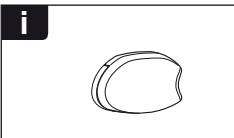
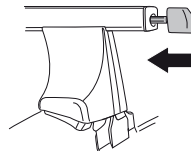

i

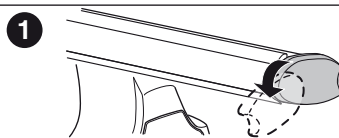

1

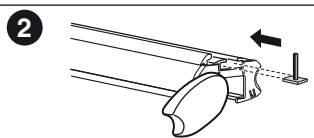

2

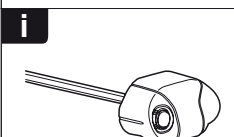

i

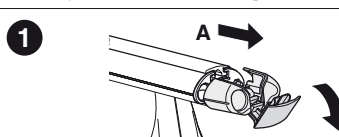

1

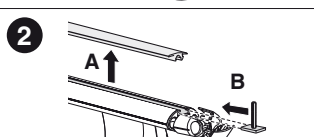

2

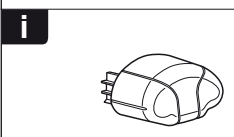

i

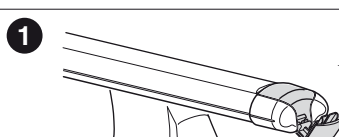

1

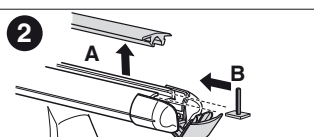

2



**THULE**  
SWEDEN  
**ONE  
KEY  
SYSTEM**



- 544 (x4)
- 596 (x6)
- 588 (x8)
- NA 510 (x10)
- EUR 452 (x12)
- ASIA



WW ▶ Thule Sweden AB, Box 69, 330 33 Hillerstorp, SWEDEN  
NA ▶ Thule Inc., 42 Silvermine Road, Seymour, Connecticut 06483, USA

info@thule.com  
customer.service@thule.com

www.thule.com